

# Spule / Reel/MT 396 / 305

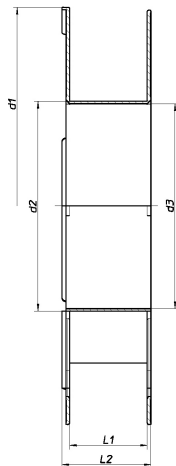
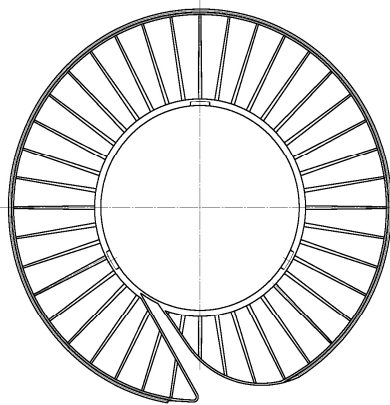
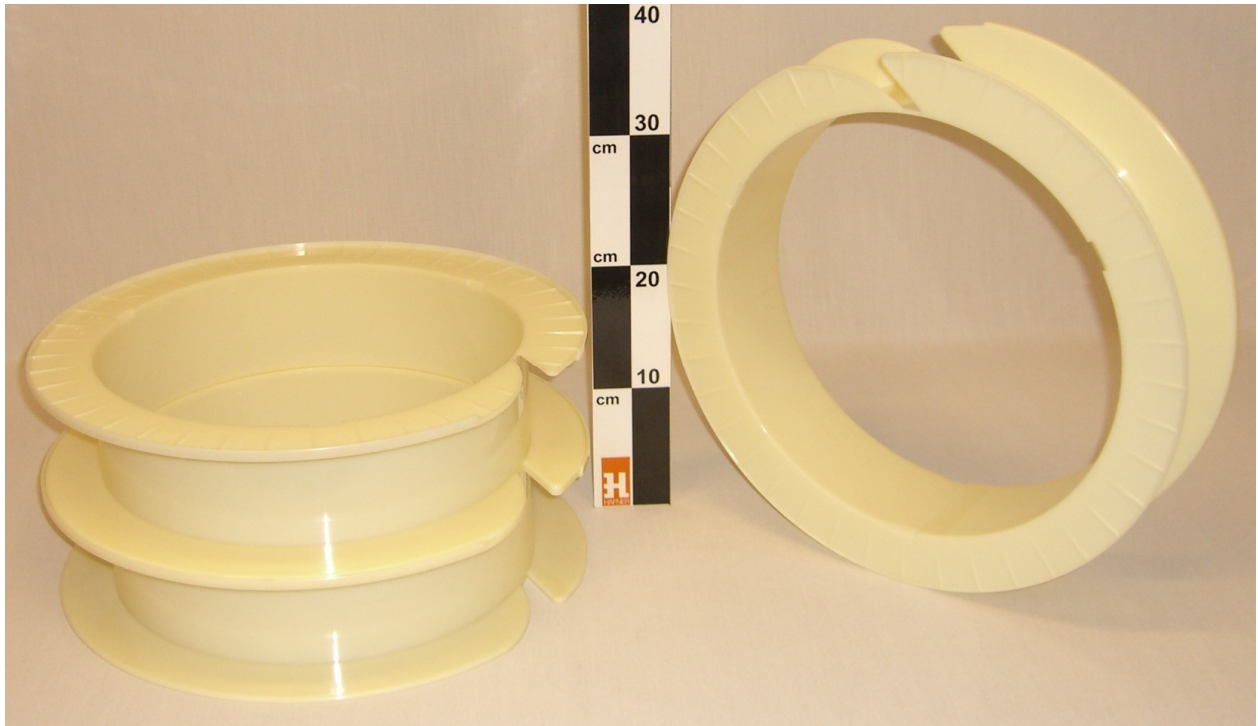

**Maße / dimensions :**

<b>d 1</b>	[ mm ]	<b>396</b>	<b>15,6</b>	[inch]
<b>d 2</b>	[ mm ]	<b>310</b>	<b>12,2</b>	[inch]
<b>d 3</b>	[ mm ]	<b>305</b>	<b>12,0</b>	[inch]
<b>L 1</b>	[ mm ]	<b>92</b>	<b>3,6</b>	[inch]
<b>L 2</b>	[ mm ]	<b>80</b>	<b>3,1</b>	[inch]
<b>V</b>	[ cm <sup>3</sup> ]	<b>3814</b>	<b>233</b>	[inch <sup>3</sup> ]

<b>Material / material:</b>	Spule aus SAN Auch andere Qualitäten lieferbar	/	reel SAN also available in other material qualities
<b>Besonderheiten / peculiarity:</b>	Unter Reinraumbedingungen ( Klasse D ) produzierte Spule	/	spools produced under cleanroom conditions ( class D )
<b>Einsatzzweck / application:</b>	In der Medizintechnik für das Wickeln von Schläuchen und Kanülen	/	in the area of medical technology for winding tubes and canules
<b>Verpackung / packaging:</b>	45 Stck. im Karton 120 x 80 x 850 cm	/	45 pcs. per carton; dim. 47 x 31 x 33 inch